

**GEO-ing d.o.o.**

za geodeziju, projektiranje i zastupanje  
Ogulin, B. Frankopana 4

MB 1732536, žiro rač. 2402006-1100402093

E-mail : geo.ing.og@gmail.com

mobilni tel / 098 861-536

tel / 047-801 536

fax./047-801 538

**Naručitelj:**

**HOC BJELOLASICA d.o.o. u stečaju**

**Vrelo bb, Jasenak,**

**OIB: 50919159681.**

## **GEODETSKI SNIMAK**

**vodocrpilišta "Vrelo"**

**na k.č. br. 2666**

**K.O. Jasenak**

**Izradio:**

GEO – ing d.o.o

Ogulin

**Ovlašteni inženjer**

Dragan Furić, dipl.ing. geod.

**listopad, 2022 god.**

## **SADRŽAJ**

- 1)      TEHNIČKO IZVJEŠĆE
- 2)      GEODETSKI SNIMAK VODOCRPILIŠTA VRELO S  
PREKLOP KATASTARKOG PLANA U MJERILU 1:500
- 3)      POPIS KOORDINATA VODOCRPILIŠTA

## TEHNIČKI IZVJEŠTAJ

Na zahtjev naručitelja HOC BJELOLASICA d.o.o. u stečaju Vrelo bb, Jasenak, OIB: 50919159681 izvršili smo geodetsko snimanje vodocrpilišta Vrelo i dijela vodovodne mreže naselja Vrelo prema pokazivanju stanovnika naselja u K.O. Jasenak. Na tako snimljeni detalj preklopljen je važeći katastarski plan.

Snimanje smo izvršili dvofrekventnim TOPCON-ovim GPS uređajem. Kao sustav za pozicioniranje korišten je CROPOS s kojim je uspostavljena veza putem mobilnog interneta. Od usluga koje CROPOS pruža koristili smo VPPS ( visoko precizni servis pozicioniranja ).

Snimanje na terenu vodio je diplomirani inženjer geodezije Dragan Furić.

Obrada podataka i geodetska računanja obavljena su uz pomoć programskog paketa TOPCON, a crtanje u programu CAD software (programa) Autodesk Civil 3D 2008 SLM i Geo Suite 6.00.74 SL.

U Ogulinu 04.10.2022. god.

Izvještaj sastavio:

Dragan Furić dipl.ing.geod.



K. O. Jasenak  
k.č. br. 2666 i dr.

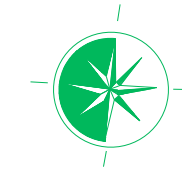

Geo-ing d.o.o.  
Ogulin, B. Frankopana 4

## Geodetski snimak crpilišta Vrelo sa preklapom katastarskog plana

Mjerilo 1:500

Legenda:

trasa vodovoda	
katastar	
visina terena	154.85
čelični poklopac šaht	
žičana ograda	
željezna ograda	
pokos	
objekti	

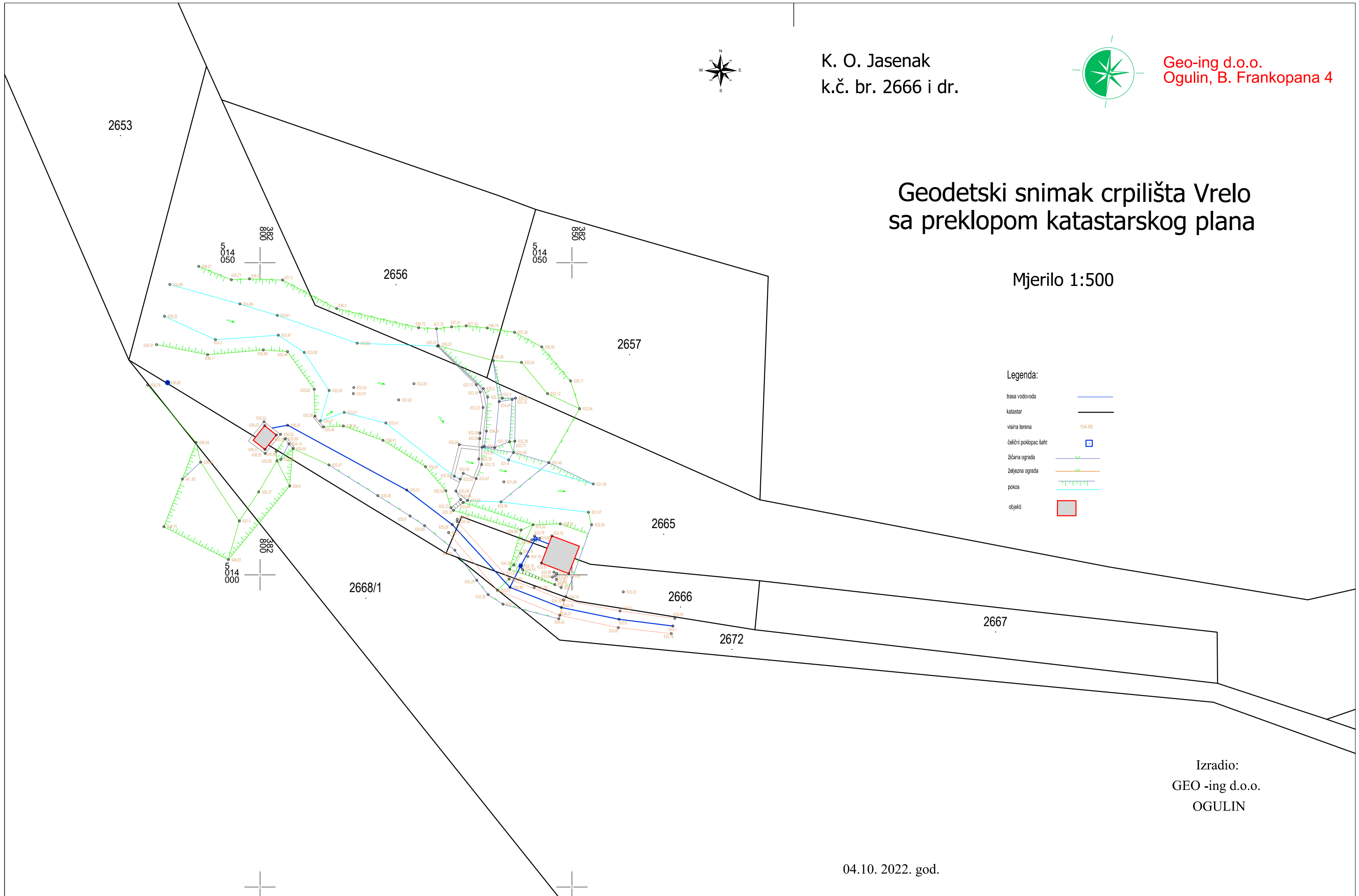

Izradio:  
GEO -ing d.o.o.  
OGULIN

04.10.2022. god.

# POPIS KOORDINATA SNIMLJENIH TOČAKA

Br. točke	E	N	h
1	382802.62	5014022.38	635.98
2	382803.30	5014022.50	636.03
3	382800.74	5014023.91	636.07
4	382800.62	5014024.52	635.93
5	382800.78	5014020.06	636.05
6	382800.82	5014019.43	636.07
7	382802.72	5014018.26	635.95
8	382802.59	5014019.77	636.06
9	382804.03	5014021.79	635.69
10	382805.28	5014020.20	635.64
11	382804.62	5014020.97	634.14
12	382803.32	5014018.51	634.28
13	382799.78	5014013.27	636.37
14	382796.68	5014008.62	637.40
15	382790.48	5014018.05	636.61
16	382789.75	5014021.20	636.58
17	382781.97	5014030.39	636.78
18	382785.18	5014030.78	636.88
19	382783.43	5014036.87	636.51
20	382791.60	5014035.25	636.11
21	382800.52	5014036.01	635.68
22	382804.39	5014035.74	635.44
23	382808.68	5014029.70	635.62
24	382808.79	5014025.42	635.56
25	382810.18	5014023.70	635.48
26	382809.68	5014024.66	634.07
27	382813.35	5014023.84	635.36
28	382819.70	5014021.55	635.41
29	382826.52	5014017.31	634.91
30	382829.77	5014013.47	635.08
31	382830.61	5014010.74	635.33
32	382830.98	5014010.31	635.35
33	382832.16	5014012.05	633.64
34	382832.54	5014011.57	633.69
35	382833.26	5014011.91	633.55
36	382831.39	5014013.41	633.59
37	382832.07	5014015.32	633.53
38	382831.13	5014015.78	632.93
39	382832.56	5014016.25	633.54
40	382834.63	5014015.42	633.47
41	382835.50	5014017.67	633.15
42	382835.59	5014020.42	633.26
43	382835.21	5014021.82	632.94
44	382831.91	5014020.84	632.94

45	382835.73	5014026.80	633.23
46	382835.28	5014029.27	633.18
47	382834.64	5014030.45	633.15
48	382835.23	5014022.70	632.26
49	382835.06	5014018.56	632.35
50	382835.95	5014020.60	634.11
51	382836.27	5014023.01	634.91
52	382836.48	5014028.47	635.13
53	382835.78	5014029.83	635.30
54	382828.58	5014036.70	636.02
55	382828.43	5014036.64	635.03
56	382830.70	5014039.72	637.41
57	382828.28	5014039.42	637.22
58	382825.41	5014039.57	636.72
59	382812.29	5014042.64	636.50
60	382803.61	5014047.21	637.30
61	382798.32	5014047.40	636.51
62	382795.39	5014047.27	635.77
63	382790.16	5014049.40	636.01
64	382785.54	5014046.50	634.88
65	382784.69	5014041.40	635.22
66	382792.86	5014037.68	634.30
67	382796.78	5014043.38	634.46
68	382802.76	5014041.56	633.61
69	382802.93	5014038.39	633.47
70	382807.07	5014035.63	633.88
71	382811.08	5014029.52	633.59
72	382813.49	5014026.02	633.27
73	382820.15	5014024.32	633.41
74	382822.21	5014028.01	632.92
75	382824.65	5014030.61	632.83
76	382815.57	5014037.09	633.59
77	382814.95	5014029.02	632.91
78	382815.01	5014029.99	633.53
79	382833.04	5014039.87	637.43
80	382787.56	5014015.33	641.65
81	382784.60	5014007.71	647.75
82	382794.92	5014002.42	644.81
83	382804.75	5014014.21	639.40
84	382811.04	5014017.60	635.47
85	382818.88	5014012.68	635.45
86	382824.03	5014009.42	635.60
87	382826.38	5014007.86	635.65
88	382831.21	5014003.93	635.51
89	382839.98	5014000.89	634.92
90	382840.64	5014001.57	634.38
91	382841.81	5014007.18	634.66

92	382834.73	5013999.11	635.25
93	382836.55	5013996.82	635.26
94	382838.93	5013995.29	635.00
95	382847.88	5013992.95	634.45
96	382848.03	5013993.53	634.33
97	382848.60	5013995.98	634.19
98	382849.01	5013996.50	634.14
99	382848.25	5013997.95	634.11
100	382847.23	5013998.42	634.14
101	382847.54	5014000.19	634.17
102	382847.11	5014000.43	633.86
103	382846.84	5013999.63	633.84
104	382847.49	5013999.26	633.86
105	382847.28	5013999.84	633.87
106	382849.49	5014000.20	633.85
107	382845.08	5014001.87	633.87
108	382842.04	5014000.87	634.18
109	382841.78	5014001.44	634.19
110	382842.93	5014002.94	634.16
111	382841.79	5014003.43	634.18
112	382843.99	5014006.22	633.76
113	382843.54	5014005.58	633.92
114	382844.83	5014005.85	633.86
115	382843.74	5014008.03	633.32
116	382846.77	5014006.24	633.35
117	382848.11	5014008.15	633.39
118	382853.13	5014008.03	632.24
119	382852.64	5014010.03	631.47
120	382853.40	5014014.53	631.36
121	382838.62	5014011.68	633.34
122	382839.06	5014014.88	631.84
123	382839.82	5014018.39	631.60
124	382840.63	5014019.59	632.56
125	382846.27	5014017.96	632.46
126	382851.21	5014026.62	632.84
127	382849.77	5014031.06	635.11
128	382846.06	5014029.03	632.12
129	382845.15	5014036.50	636.92
130	382841.90	5014034.02	633.04
131	382840.78	5014038.85	637.39
132	382836.40	5014039.53	636.74
133	382837.36	5014034.32	634.26
134	382838.31	5014027.74	634.24
135	382838.83	5014028.29	632.50
136	382840.39	5014028.08	633.75
137	382840.94	5014028.31	632.57
138	382839.99	5014021.32	633.77

139	382840.84	5014021.39	632.36
140	382837.60	5014020.37	632.76
141	382831.59	5014008.53	635.04
142	382830.21	5014006.75	635.46
143	382831.60	5014008.90	635.45
144	382838.03	5013997.52	635.01
145	382839.92	5013999.32	634.89
146	382843.94	5013997.97	634.79
147	382857.40	5013991.55	633.67
148	382857.68	5013994.20	633.53
149	382858.21	5013997.27	633.23
150	382866.47	5013993.02	633.04
151	382865.90	5013990.58	633.18
152	382804.41	5014023.94	635.97
153	382823.50	5014013.58	635.07
154	382830.81	5014008.04	635.26
155	382840.06	5013998.00	634.89
156	382848.26	5013994.79	634.26
157	382857.53	5013992.88	633.60
158	382866.17	5013991.80	633.10

